

EZ-LIGHT® S18L

Part as S18DLGRYPQ

Datasheet

DC-Operated LED Indicators with One, Two, or Three Colors

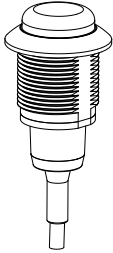

- Up to three independent colors in one unit
- Translucent face appears gray when off to avoid false indication
- M12 Euro connector models available for plug and play indication
- Wide 180° field of view
- Wide 10 to 30 V dc operating range allows for use in battery powered mobile applications
- Available with PNP or NPN input, depending on model
- IP69K rated to withstand harsh wash-down environments
- Wide operating range of -40 °C to +50 °C (-40 °F to +122 °F)
- Daylight visible models with a clear cover and more focused light output provide greater visibility in high ambient light conditions

Models

Table 1: Standard Models

Family	Color 1	Color 2	Color 3	Input	Connector
S18L	G	R	Y	P	Q
MODEL KEY	G = Green R = Red Y = Yellow B = Blue W = White O = Orange T = Turquoise V = Violet M = Magenta X = No color in this position			P = PNP N = NPN	Q = 4 pin Euro QD Blank = 2 meter cable OP = Euro Pigtail QD T = 4 screw terminals

Table 2: Daylight Visible Models

Family	Color 1	Color 2	Color 3	Input	Connector
S18DL	G	R	Y	P	Q
MODEL KEY	G = Green R = Red Y = Yellow B = Blue W = White O = Orange X = No color in this position			P = PNP N = NPN	Q = 4 pin Euro QD Blank = 2 meter cable OP = Euro Pigtail QD T = 4 screw terminals

Example Model	Indicators	Input	Connector Type
S18LGRYP	Green, Red, Yellow	PNP	blank = 2 m cable
S18LGXXPQ	Green	PNP/NPN	4-pin Euro QD
S18LGRXPQP	Green, Red	PNP	Euro Pigtail QD
S18LGRYPT	Green, Red, Yellow	PNP	4 screw terminals

NOTE: Single color models should be ordered as PNP models but can be wired for either PNP or NPN input.

Wiring Diagrams

Multi Color Wiring

NPN

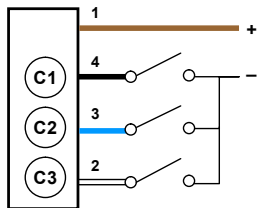

PNP

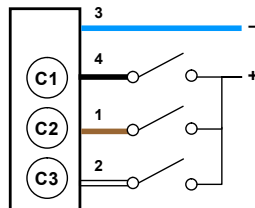

1 = Brown
2 = White
3 = Blue
4 = Black

C1 = Color 1
C2 = Color 2
C3 = Color 3

Single Color Wiring

NPN

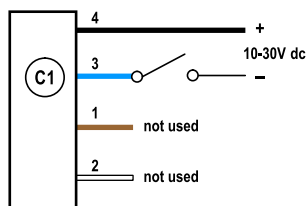

PNP

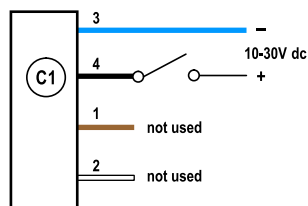

Specifications

Supply and Voltage Current

10 to 30 V dc at 25 mA max. per LED color

Indicators

LEDs are independently selected; 1, 2, or 3 colors, depending on model. For other colors/combinations, contact Factory for availability

Standard Models: Entire translucent dome provides even indication viewable from over 180 degrees

Daylight Visible Models: Clear dome and more focused light provides even brighter indication when used in high ambient light areas

Input Response Time

Indicator ON/OFF: 1 ms max

Construction

UV stabilized polycarbonate housing
PBT mounting nut max torque 2.3 N-m (20 lbf-in)
Nitrile sealing washer

Connections

4-pin Euro-style integral QD (Q), 150 mm (5.9 in) PVC pigtail QD (QP), or 4-wire, 2 m (6.5 ft) PVC integral cable, 4 color-coded screw terminals for up to 16 AWG wire, depending on model, screw terminal max. torque 0.11 N-m (1.0 lbf-in)

Environmental Rating

Rated IEC IP67, and IP69K, per DIN 40050-9. Cabled models also meet IP69K if the cable and cable entrance are protected from high-pressure spray. Indicator side of terminal models meet IP67, and IP69K when installed in an enclosure. Screw connection points meet IP00

Meets UL Type 4X and 13 when used with a suitable enclosure

Operating Conditions

-40 °C to 50 °C (-40 °F to 122 °F)

Limited to one color on at a time

Certifications



Dimensions

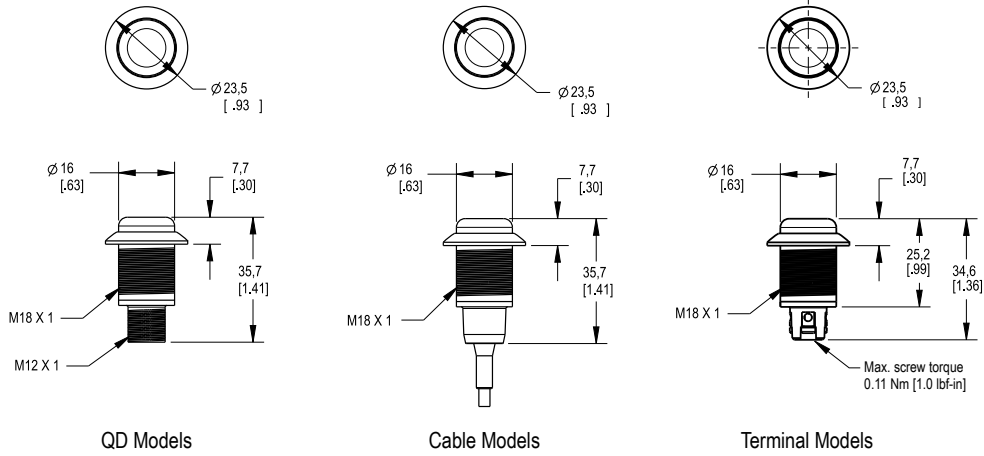

Cordsets

4-Pin Threaded M12/Euro-Style Cordsets				
Model	Length	Style	Dimensions	Pinout
MQDC-406	1.83 m (6 ft)	Straight		
MQDC-415	4.57 m (15 ft)			
MQDC-430	9.14 m (30 ft)			
MQDC-450	15.2 m (50 ft)			
MQDC-406RA	1.83 m (6 ft)	Right-Angle		<p>1 = Brown 2 = White 3 = Blue 4 = Black</p>
MQDC-415RA	4.57 m (15 ft)			
MQDC-430RA	9.14 m (30 ft)			
MQDC-450RA	15.2 m (50 ft)			

Mounting Brackets

All measurements are listed in millimeters.

SMB18A

- Right-angle mounting bracket with a curved slot for versatile orientation
- 12-ga. stainless steel
- 18 mm sensor mounting hole
- Clearance for M4 (#8) hardware

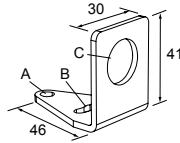

Hole center spacing: A to B = 24.2
 Hole size: A = \varnothing 4.6, B = 17.0 x 4.6, C = \varnothing 18.5

SMBAMS18P

- Flat SMBAMS series bracket with 18 mm hole
- Articulation slots for 90+° rotation
- 12-ga. (2.6 mm) cold-rolled steel

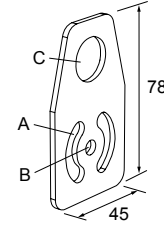

Hole center spacing: A = 26.0, A to B = 13.0
 Hole size: A = 26.8 x 7.0, B = \varnothing 6.5, C = \varnothing 19.0

SMB18AFA..

- Protective, swivel bracket with tilt and pan movement for precision adjustment
- Easy sensor mounting to extruded rail T-slots
- Metric and inch size bolts available
- Mounting hole for 18 mm sensors

Hole size: B = \varnothing 18.1

Model	Bolt Thread (A)
SMB18AFA	3/8 - 16 x 2 in
SMB18AFAM10	M10 - 1.5 x 50

SMBAMS18RA

- Right-angle SMBAMS series bracket with 18 mm hole
- Articulation slots for 90+° rotation
- 12-ga. (2.6 mm) cold-rolled steel

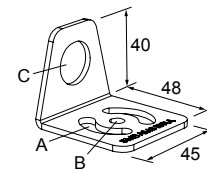

Hole center spacing: A = 26.0, A to B = 13.0
 Hole size: A = 26.8 x 7.0, B = \varnothing 6.5, C = \varnothing 19.0

SMBC18

- 18 mm sensor mounting hole
- Snaps onto 28 mm diameter structural framing

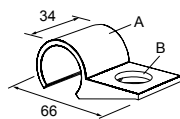

A = \varnothing 26.9 mm
 Hole size: B = \varnothing 18.4

LMB1822FM

- Adaptor for mounting the S18L into standard 22 mm holes
- Includes adaptor, nut, and gasket

